

# CUSTOM PIPE & COUPLING INC.

## FLANGES

### Class 125 Flanges

Standard flanges are plain-faced without projection or raised faces and are furnished smooth or with shallow serrations (re: table 15.3 ANSI/AWWA C115/A21.15).

Either ductile-iron or gray-iron flanges may be used unless otherwise specified by the owner. Flanges shall conform to the respective chemical and physical properties specified for gray-iron and ductile iron fittings in ANSI/AWWA C110/A21.10, Standard for Ductile-Iron and Gray-Iron Fittings, 3 in. through 54 in., for Water and Other Liquids. Flanges are to be adequately marked as C. I. or D. I., Class Rating, Manufacturer or Fabricator's mark if different from manufacturer.

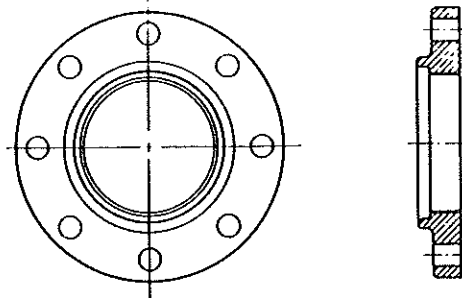

These flanges are adequate for water service of 250 psi working pressure. Bolt circle and bolt holes can be joined with Class 125 ANSI B16.1 or Class 150 ANSI B16.5 flanges. However, these flanges cannot be joined with Class 250 ANSI B16.1 flanges, flanged fittings and valves.

### Class 250 Flanges

These flanges as shown in ANSI B16.1 are larger, thicker and possess different bolt circles and may have more bolt holes. They cannot be joined to Class 125 flanges. They are rated for 250 psi working pressure.

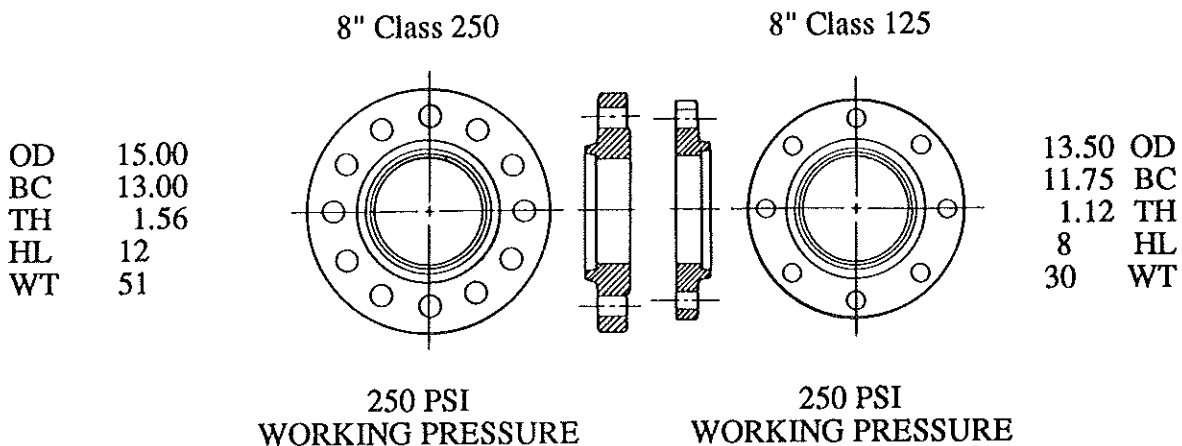

Note: Class 250 flanges have raised faces. If Class 250 flanges have raised faces, they should not be mated with flat faced Class 250 flanges.

# CUSTOM PIPE & COUPLING INC.

## BASIC DIMENSIONS OF STANDARD TAPER PIPE THREAD FOR DUCTILE IRON PIPE

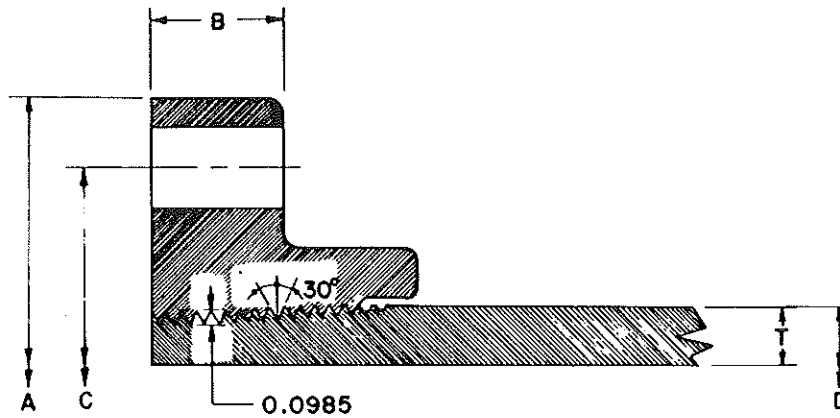

Nom. Pipe Size	A. Flange O.D.	B. Flange Thickness	C. Bolt Circle	D. Pipe O.D.	T. Nominal Thickness	Dia. Bolt Holes	Bolt Size	Number of Bolts
3"	7.50	0.75	6.00	3.96	0.31	3/4	3/8 x 2 1/2	4
4"	9.00	0.94	7.50	4.80	0.32	3/4	3/8 x 3	8
6"	11.00	1.00	9.50	6.90	0.34	7/8	3/4 x 3 1/2	8
8"	13.50	1.12	11.75	9.05	0.36	7/8	3/4 x 3 1/2	8
10"	16.00	1.19	14.25	11.10	0.38	1	7/8 x 4	12
12"	19.00	1.25	17.00	13.20	0.40	1	7/8 x 4	12
14"	21.00	1.38	18.75	15.30	0.42	1 1/8	1 x 4 1/2	12
16"	23.50	1.44	21.25	17.40	0.43	1 1/8	1 x 4 1/2	16
18"	25.00	1.56	22.75	19.50	0.44	1 1/4	1 1/8 x 5	16
20"	27.50	1.69	25.00	21.60	0.45	1 1/4	1 1/8 x 5	20
24"	32.00	1.88	29.50	25.80	0.47	1 1/2	1 1/4 x 5 1/2	20
30"	38.75	2.12	36.00	32.00	0.51	1 3/4	1 1/4 x 6 1/2	28
36"	46.00	2.38	42.75	38.30	0.58	1 3/4	1 1/2 x 7	32
42"	53.00	2.62	49.50	44.50	0.65	1 3/4	1 1/2 x 7 1/2	36
48"	59.50	2.75	56.00	50.80	0.72	1 3/4	1 1/2 x 8	44
54"	66.25	3.00	62.75	57.10	0.81	2	1 3/4 x 8 1/2	44

### NOTES

- All ductile iron pipe used with threaded flanges to have a minimum thickness of Class 53.
- Thickness of flanges have the following tolerance:
  - 3" thru 12" -  $\pm .12"$  - .065
  - 14" thru 24" -  $\pm .19"$  - .095
  - 30" thru 54" -  $\pm .25"$  - .125
- All ductile iron pipe sizes 3" thru 54" to have American Standard Pipe Threads: 8 threads/in. on a taper of .75 in./ft. on diameter.